

# QUICK START GUIDE FREESTYLE® COMFORT®



# 1

## Unpack Your FreeStyle® Comfort®



Universal Power Supply



Carrying Bag



DC Power Cord



8-cell Battery Pack\*



### OTHER ITEMS AVAILABLE FOR PURCHASE:

- 16-cell Battery Pack
- Desktop Battery Pack Charger
- Shoulder Strap
- Carry-all Accessory Bag

*\*or 16-cell Battery Pack*

# QUICK START GUIDE FREESTYLE® COMFORT®

## 2 Getting to Know Your FreeStyle® Comfort®

Review all Warnings, Cautions and additional device information in the FreeStyle Comfort User Manual.

Become familiar with the key features of the FreeStyle Comfort and the User Control Panel.

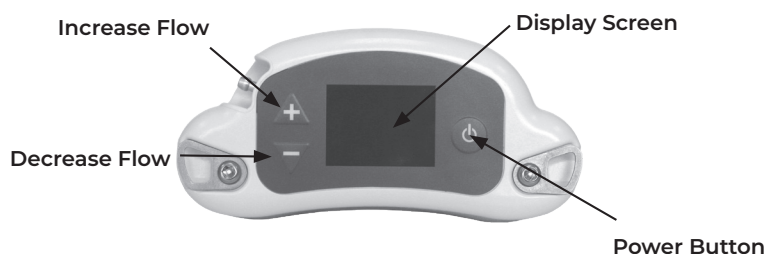
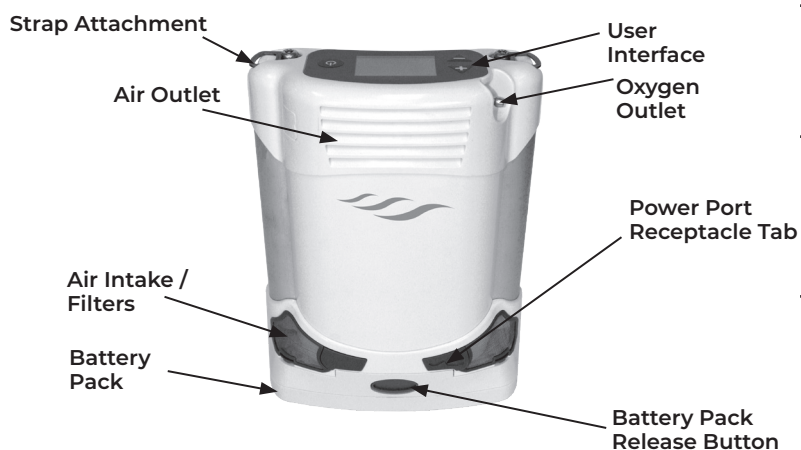

Display Screen On AC/DC Power

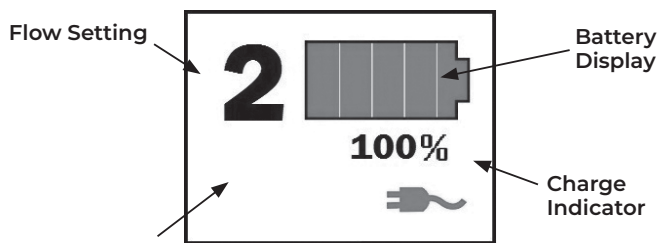

Alarm Display Space

Turning on the FreeStyle Comfort	Turn on the FreeStyle Comfort by pressing the power button and select your prescribed flow setting utilizing the increase (+) or decrease (-) flow buttons.
----------------------------------	---

Flow Selection Buttons	To change the flow setting, press the increase (+) or decrease (-) flow buttons to the desired flow rate. It is normal to hear a difference in sound as you change the flow settings.
------------------------	---

Alarm Display Space	Indicates an alarm condition on the concentrator. Refer to the troubleshooting table in the User Manual, and contact your CAIRE Inc. or your home care provider if necessary for assistance.
---------------------	--

Battery Display	View the battery gauge indicator on the user interface to determine how much charge is remaining on the installed battery pack.
-----------------	---

Checking the Battery Pack Charge	To check the battery charge when it is installed in the FreeStyle Comfort, reference the battery icon and the battery percentage remaining on the display.
----------------------------------	--

To check the battery charge when it is not installed in the FreeStyle Comfort, lay it flat and press the TEST button. The battery gauge indicator lights (25-100%) will illuminate to the right of the TEST button to indicate the level of the battery pack charge.

**Alarm:** A brief audible alarm (or buzzer) will sound to alert you to the operating condition of the device, either a warning or failure, and confirms a valid key press.

**Note:** If a control panel button has not been pressed in 20 seconds the display screen will dim. The screen will go dark, but the unit will continue to run. To wake up the display screen simply press any of the control panel buttons once.

Display Screen On Battery

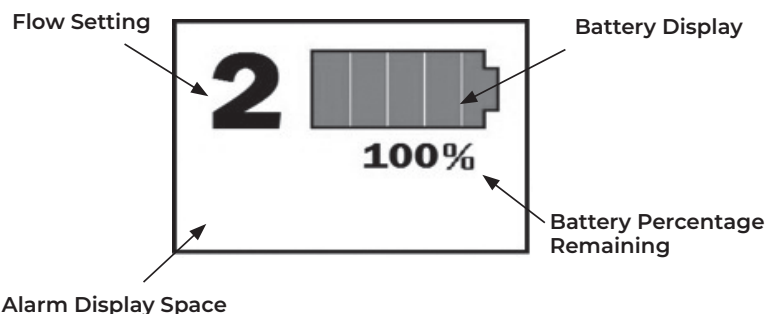



# QUICK START GUIDE FREESTYLE® COMFORT®

## 3 Getting Started

### 1) Install the Battery Pack:

**A.** Align the battery with the bottom housing from the center of the FreeStyle Comfort. **B.** Slide the battery inward until you hear a click to confirm that it has locked in place.



### 2) Connect External Power

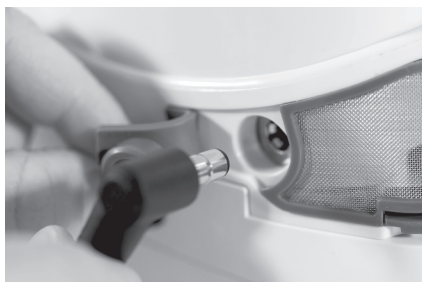

Connect one end of the AC power cord to the inlet on the power supply brick. Connect the other end to a wall outlet.



Shown Above is the FreeStyle Comfort Power Supply



## 4 Charging the Battery

The FreeStyle Comfort will recharge the battery pack anytime it is installed in the concentrator and the concentrator is connected to an external AC or DC power source, unless placed in Airplane Mode.

Battery charge will be displayed on the display screen. If off, press up or down to display battery percentage.

100% is fully charged.

To check the battery charge when it is not installed in the FreeStyle Comfort, lay it flat and press the TEST button. The battery gauge indicator lights (25-100%) will illuminate to the right of the TEST button to indicate the level of the battery pack charge.



Battery Recharge Time:  
Single Battery: 3.5 Hours  
Double Battery: 6.0 Hours

# QUICK START GUIDE FREESTYLE® COMFORT®

## 5

### Begin Using the FreeStyle® Comfort®

- 1) Connect a nasal cannula to the oxygen outlet barb. Ensure the connection is secure before operation. Any cannula(s) used other than the recommended may affect performance.

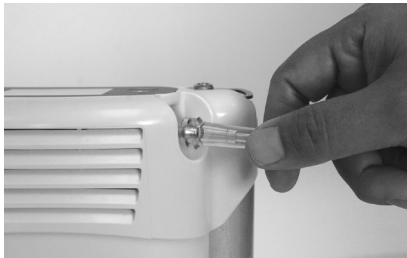

- 2) Turn on the FreeStyle Comfort by pressing the power button and select your prescribed flow setting utilizing the increase (+) or decrease (-) flow buttons.



A brief audible alarm will sound to indicate the device has powered on and the display will turn on.

- 3) Position the nasal cannula on your face per the manufacturer's instructions provided with the cannula and breathe normally. You should feel a puff of oxygen delivered through the nasal cannula each time you inhale.
- 4) To change the flow setting, press the increase (+) or decrease (-) flow buttons to the desired flow rate. It is normal to hear a difference in sound as you change the flow settings.



## 6

### Regular Maintenance

Air enters the FreeStyle Comfort through two air intake filters located on the bottom, lower front of the oxygen concentrator. The filters prevent dust and other large particles in the air from entering the unit.

At least once per week, the Air Intake Filters should be cleaned.

- 1) Remove the air intake filter on the left side.



- 2) Remove the air intake filter on the right side.



- 3) Wash the filters in a warm solution of soap and water.
- 4) Rinse the filter thoroughly and remove excess water with a soft, absorbent towel. Ensure the filter is completely dry before replacing it.
- 5) Replace the clean and dry filter in the filter cover and re-install the filter cover in the FreeStyle Comfort.

THIS QUICK START GUIDE IS NOT INTENDED TO REPLACE THE DETAILED INFORMATION AVAILABLE IN YOUR USER MANUAL, SO PLEASE REFER TO THE USER MANUAL FOR IMPORTANT CRITICAL INFORMATION REGARDING USE AND OPERATION OF THE PRODUCT.